

Donation Lot No 1524

River Courses

- S 69 W 9
- S 51 W 12
- N 71 W 14.5
- N 81 W 40
- N 52 W 14
- N 66 W 33
- Ps. 132.5

Geo. Plumstead

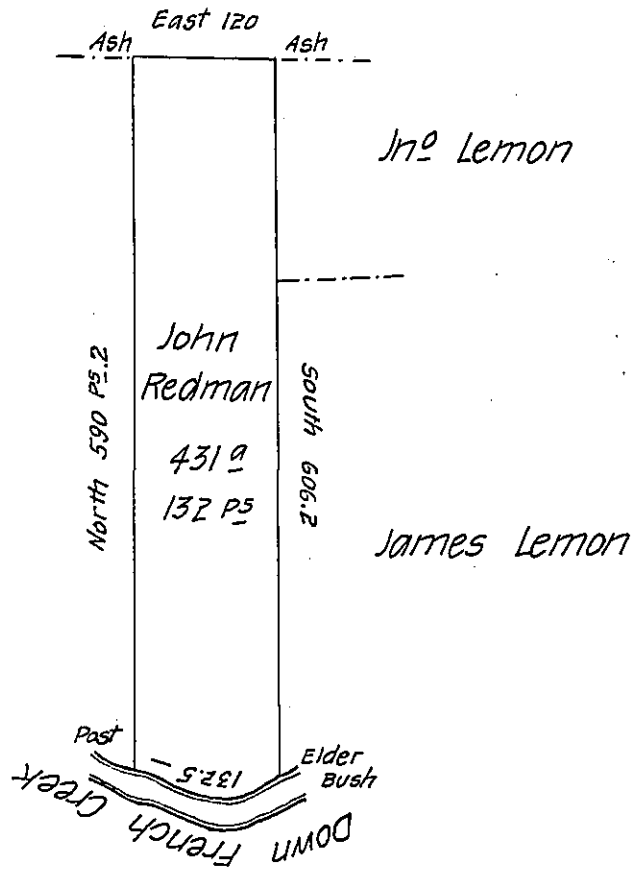

Situate on and adjoining the west side of French Creek in ALLY
 County Containing 431^a 132^{ps} and allowance of Six P. Cent &c Surveyed
 the 29th day of October 1795, in pursuance of a warrant dated the 13th
 day of April 1792.

With Power DY SR

To Dan^l Brodhead Esq^r
 Surveyor General

IN TESTIMONY that the above is a copy of the original remaining on file in
 the Department of Internal Affairs of Pennsylvania, made
 conformably to an Act of Assembly approved the 16th day of
 February, 1833, I have hereunto set my Hand and caused
 the Seal of said Department to be affixed at Harrisburg,
 this eighteenth day of March 1907.

James W. Brown
 Secretary of Internal Affairs.